

THE CORPORATION OF THE CITY OF PORT COQUITLAM
ENVIRONMENTAL PROTECTION COMMITTEE

Susan Rauh

Wednesday, April 20, 1994

Meeting Room No. 2
2580 Shaughnessy Street, Port Coquitlam, BC

5:00 p.m.

AGENDA

PERSONNEL IN ATTENDANCE:

CONFIRMATION OF MINUTES OF PREVIOUS MEETING

ITEM I: TELEPHONE BOOK RECYCLING - B.C. TEL - UPDATE

ITEM II: PINECONE LAKE - BURKE MOUNTAIN

ITEM III: OTHER BUSINESS

[Signature]
APR 20 1994

THE CORPORATION OF THE CITY OF PORT COQUITLAM
ENVIRONMENTAL PROTECTION COMMITTEE
MINUTES

A meeting of the Environmental Protection Committee was held at City Hall, 2580 Shaughnessy Street, Port Coquitlam, on Wednesday, April 20, 1994 at 5:00 p.m. in Meeting Room #2.

In attendance were:

Councillor M. Gates, Chairman
Councillor R. Talbot, Co-Chairman
J.E. Yip, P. Eng., Deputy City Engineer
F. Cheung, P. Eng., Project Engineer
C. Deakin, Engineering Secretary

The minutes for the April 13, 1994 Committee meeting were considered, read and adopted.
Carried

ITEM I: TELEPHONE BOOK RECYCLING

Committee reviewed a memorandum from the Project Technician informing Committee that suggestions for locations included Hyde Creek, Terry Fox Library and the New Works Yard Transfer Station. Committee suggested that the Project Engineer try to get in contact with Poco Place Mall to see if we could have the bin there instead of Hyde Creek since Hyde Creek will temporarily be closed soon. Project Engineer will look into it and send a memo to Council for any other suggested areas.

ITEM II: PINECONE LAKE - BURKE MOUNTAIN

Committee agreed to forward a recommendation to Council supporting Option C - Full Protected Area Status which would preserve the entire Pinecone Lake - Burnaby Mountain study area.

ITEM III: OTHER BUSINESS

a) Seaboard Advertising - GVRD Campaign

Committee approved the recommendation to support through donation of municipal ad space, all Transit Shelter Campaigns Except phone book recycling at a previous meeting. A copy of the posters that will be used were copied for Committee's approval. This recommendation will be forwarded to Council.

b) Earth Day - Earthwise Magazine

Committee agreed with staff recommendation to donate a worm composter to the Wilson Centre, which is local involvement, for Earth Day rather than to Earthwise Magazine for a prize draw.

c) Proposed Tree Planting Locations - BFI

Committee approved the recommendation to have Evergreens planted in the Thompson Park area and Silver Maples on the south side of Kingsway with the funds donated from BFI.

Cont'd .../2

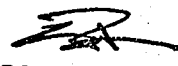
APR 20 1994

d) Proposed Advertisement - Receptacle Limit

Committee reviewed the final draft for the advertisement on Recycling/Receptacle Limits in Port Coquitlam. The Project Engineer will have the ad run in the local newspapers at the beginning of May.

There being no further business the meeting adjourned at 5:45 pm.

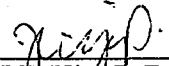

J.E. Yip, P. Eng.
Deputy City Engineer

JEY/cd

Councillor M. Gates
Committee Chairman

NOTE Minutes not read and adopted by the Committee until certified correct by the Chairman's signature.

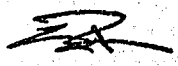
cc: Mayor and Councillors
City Administrator
City Engineer
Project Engineer
Project Technician

APR 20 1994

THE CORPORATION OF THE
CITY OF PORT COQUITLAM

MEMORANDUM

TO: Environmental Protection Committee DATE: April 15, 1994
FROM: Anne T. Pynenburg
Project Technician
SUBJECT: UPDATE ON TELEPHONE BOOK RECYCLING - BC TEL

BACKGROUND & COMMENTS:

Further discussion with Tom Wishlow of BC Tel resulted in the following clarifications:

The bins will be dropped off by Laidlaw at the request of BC Tel after we have submitted the exact locations for drop-off,

BC Tel, at the request of Laidlaw, would like a person at each site to show them the exact location where the bins are to be placed,

The bins will be picked up only when full, contrary to the original discussion of a once/week pick-up. This will require that a staff member will have to monitor the bins and contact BC Tel when they are full and require a pick-up,

Telephone books in Port Coquitlam will be out May 31st, 1994 therefore, the bins will be dropped on the week of May 31st,

Submission of our bin locations should be sent to BC Tel by mid-May,

As stated previously, all transportation and advertising will be covered by BC Tel.

Attached are 3 possible locations for bin placement; open for discussion.

Anne T. Pynenburg
Project Technician

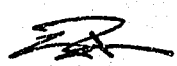
APR 20 1994

THE CORPORATION OF THE
CITY OF PORT COQUITLAM

MEMORANDUM

TO: Environmental Protection Committee

DATE: April 06, 1994

FROM: Anne T. Pynenburg
Project Technician

SUBJECT: **TELEPHONE BOOK RECYCLING - BC TEL**

BACKGROUND & COMMENTS:

Pamela Nel, of the G.V.R.D. Waste Reduction Dept., has passed on some information regarding the collection of telephone books in the Lower Mainland.

BC Tel is offering to set up bins at 3 locations in Port Coquitlam. The bins will be drop-off locations of white and yellow pages for residents and businesses. The target areas this year are the IC&I sectors.

The bins will be 6 yd. containers with a lockable lid and slot entry. BC Tel will pay for all advertising (including flyer distribution to businesses), bin drop-off, signage on the bins and hauling charges. They will be offering the bins for a one month period. Pick-ups will be made once per week. Bins will be available in all municipalities at the same time.

If the City is interested in participating, the contact person is Tom Wishlow at BC Tel.

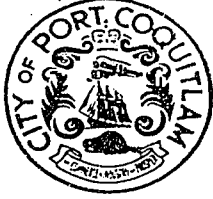

Anne T. Pynenburg
Project Technician

Apr. 14/94.

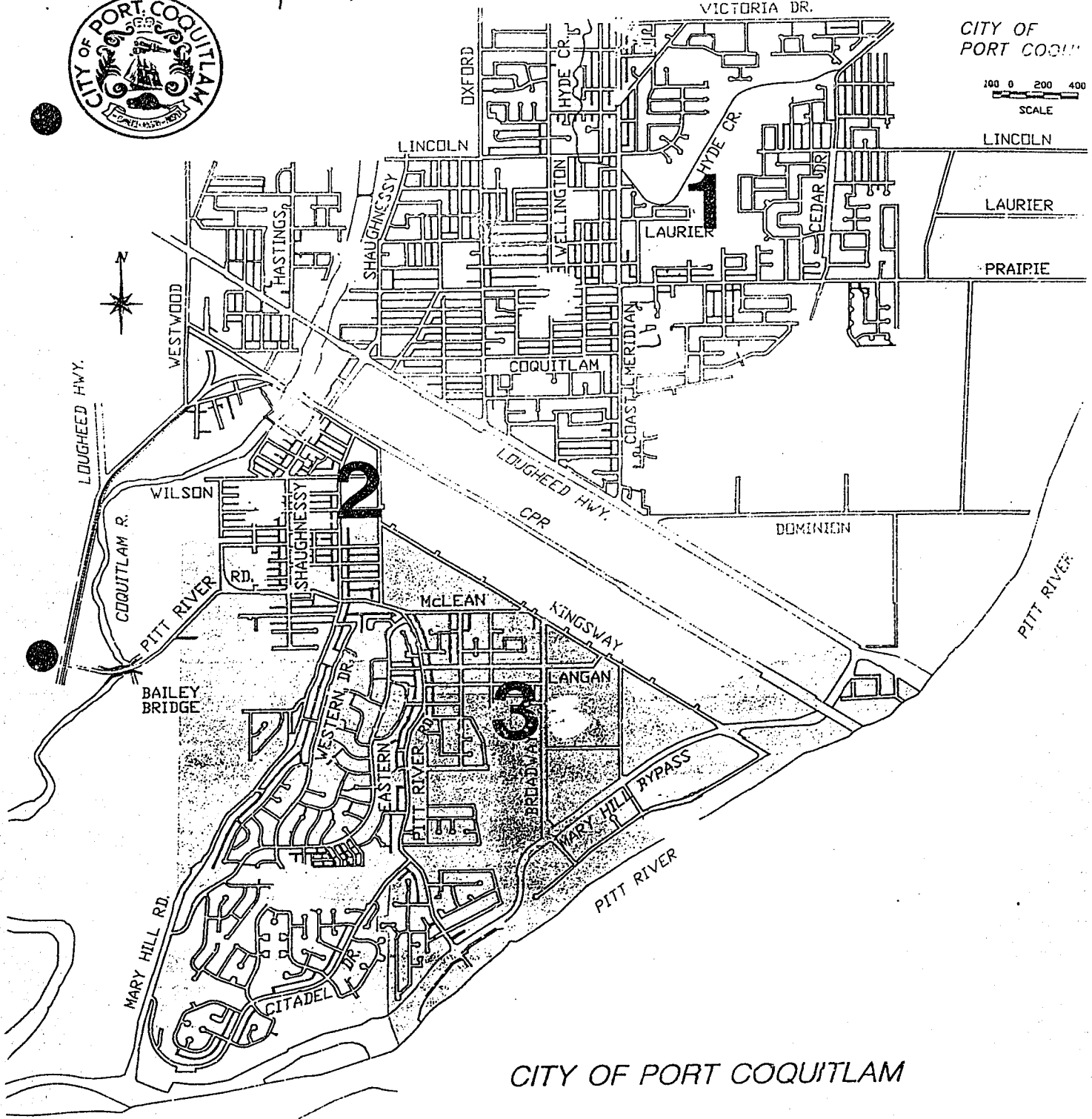

CITY OF
PORT COQUITLAM

100 0 200 400
SCALE



CITY OF PORT COQUITLAM

*Locations for Telephone
Bank Dep. Off. Bldg.*

APR 20 1994

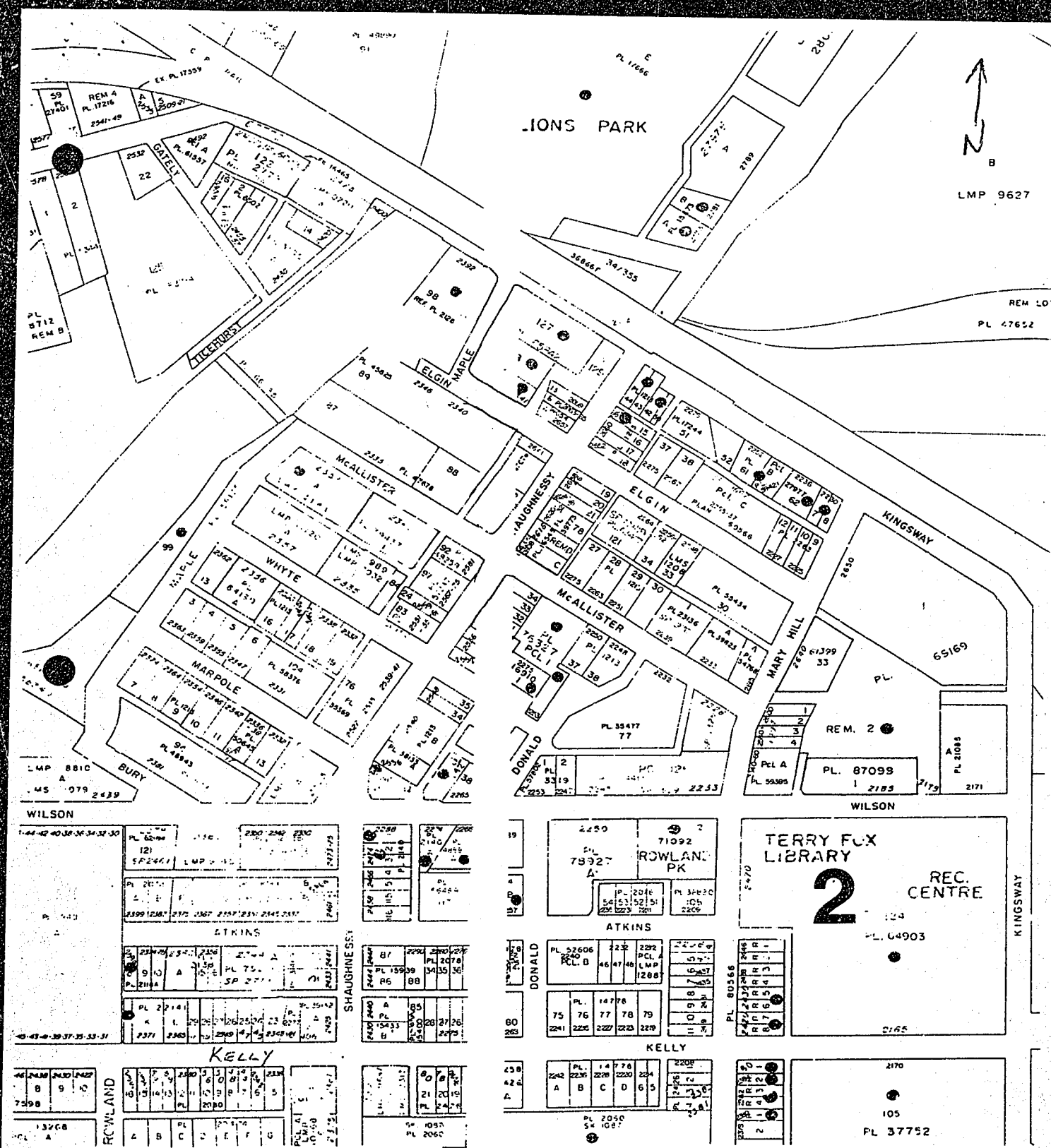

CITY OF PORT

METRIC

APR 20 1994

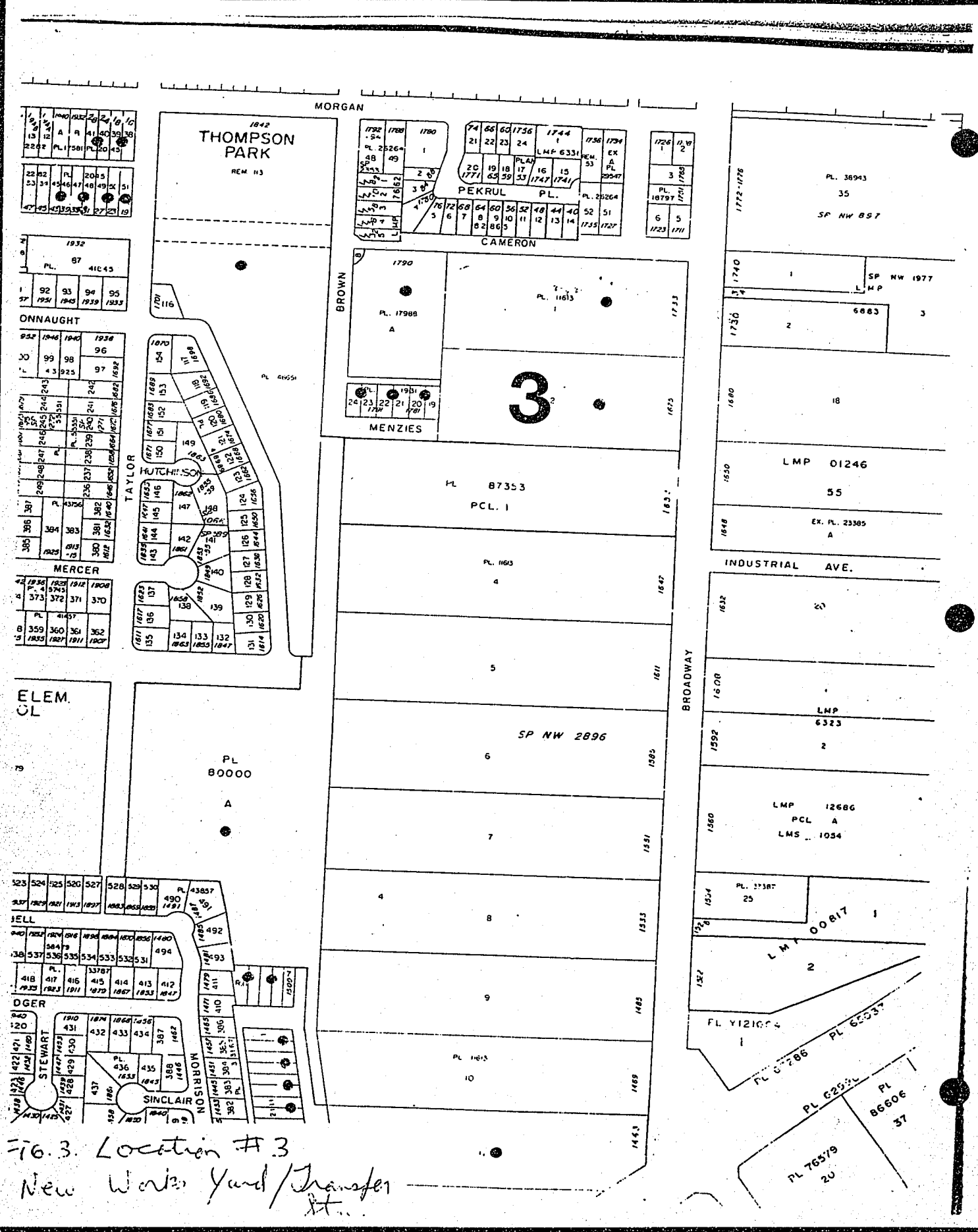

57
March 23, 1992/079

A regular meeting of the Municipal Council of the Corporation of The City of Port Coquitlam was held in the Council Chambers, Port Coquitlam City Hall, 2580 Shaughnessy Street, Port Coquitlam, B.C. on Monday, March 23rd, 1992, at 7:30 p.m.

Mayor L.M. Traboulay and Aldermen M.D. Gates, M.J. Gordon, J.J. Keryluk, M.A. Thompson and M.R. Wright were in attendance.

Also in attendance were City Administrator B.R. Kirk, Acting City Clerk S. Rauh, City Engineer I. Zahynacz, Director of Planning C.R. Felip, Director of Building Permits and Inspections J. Shardlow and Fire Chief J. Baillie.

CONFIRMATION OF MINUTES:

Moved by Alderman Keryluk:
Seconded by Alderman Gordon:

That the minutes of the Public Hearing and Regular Council meeting held on March 16th, 1992 be taken as read and adopted.

Carried.

PROCLAMATION:

WHEREAS The Canadian Ringette Championships for the Air Canada Cup will be held in Port Coquitlam from April 6 to 12, 1992;

WHEREAS Ringette players, coaches, parents and supporters will converge on Port Coquitlam from every province and territory in Canada for the Championships;

WHEREAS The Port Coquitlam Ringette Association is the largest association in British Columbia;

AND WHEREAS Ringette is a sport developed in Canada for Canadian girls and women,

NOW THEREFORE I, Leonard M. Traboulay, Mayor of the Corporation of The City of Port Coquitlam DO HEREBY PROCLAIM the week of April 6 to 12, 1992, as

"RINGETTE DAYS"

in the City of Port Coquitlam.

DELEGATION:

His Worship Mayor L.M. Traboulay introduced Mark Haddock, Burke Mountain Naturalists who addressed Council requesting support for their request to the Provincial Government to include the Burke Mountain, Widgeon Valley and Pitt Lake areas in a park study.

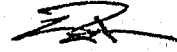
APR 20 1994

March 23, 1992/080

Moved by Alderman Gates:
Seconded by Alderman Gordon:

That Mark Haddock, Burke Mountain Naturalists request for support to the Provincial Government to include Burke Mountain, Widgeon Valley and Pitt Lake in their park study be referred to the Environmental Protection Committee and report back to Council at next Council meeting.

Carried.

BYLAWS:

Moved by Alderman Wright:
Seconded by Alderman Thompson:

That Bylaw No. 2649 be deferred for one week for further consideration.

Carried.

Moved by Alderman Wright:
Seconded by Alderman Thompson:

That Bylaw No. 2651 be deferred for one week for further consideration.

Carried.

Alderman Keryluk introduced a Bylaw to amend the "Port Coquitlam Fire Prevention Bylaw, 1991, No. 2578".

Moved by Alderman Keryluk:
Seconded by Alderman Gordon:

That Bylaw No. 2655 be read a first time.

Carried.

Moved by Alderman Keryluk:
Seconded by Alderman Gordon:

That Bylaw No. 2655 be read a second time.

Carried.

Moved by Alderman Keryluk:
Seconded by Alderman Gordon:

That Bylaw No. 2655 be read a third time.

Carried.

APR 20 1994

March 30, 1992/092

And that \$14,500 be allocated from the Special Public Works Capital Reserve Fund for this purpose.

Carried.

From the City Engineer, March 27th, 1992 regarding Appoint of Consulting Engineers for Coast Meridian Road and Prairie Road Reconstruction Projects.

Moved by Alderman Keryluk:
Seconded by Alderman Talbot:

That N.D. Lea Consultants Ltd. be appointed as Consulting Engineers for the Coast Meridian Road and Prairie Avenue reconstruction projects at an estimated cost of \$96,925 (including GST).

And that \$111,464 (\$96,925 plus 15% contingency) be allocated from the 1992 Public Works Capital Budget for this purpose.

Carried.

From the Deputy City Clerk, March 26th, 1992 regarding Burke Mountain Naturalists.

Moved by Alderman Gates:
Seconded by Alderman Gordon:

That the City support the Burke Mountain Naturalists request to the Province that they include Burke Mountain, Widgen Valley and Pitt Lake area in their park study area.

Carried.

From the Director of Planning, March 24th, 1992 regarding 1788 Salisbury Avenue Rezoning Application No. 7/92.

Moved by Alderman Wright:
Seconded by Alderman Thompson:

That this application be approved for rezoning from RS-1 to RT-1 under Section 963 of the Municipal Act subject to:

1. Satisfaction of the Engineering Department's requirements;
2. Submission of a design to the satisfaction of the Director of Planning; and
3. Registration of a covenant attaching the approved design to the property.

Carried.

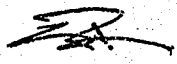
APR 20 1994

4.0 Options Under Consideration

Currently, the Pinecone Lake - Burke Mountain Study Team is considering ~~three options~~ for the study area. These options have been developed for the public review process and reflect the criteria for designation of protected areas, as well as socio-economic impacts. Other options may be considered after reviewing public input.

~~Option A~~ is a baseline scenario and does not provide protected area status over any of the study area. It assumes that the study area will continue along a path of status quo. ~~Option B~~ would protect Burke Mountain and the Widgeon Valley drainage but not include DeBeck Valley or any area to the north. ~~Option C~~ would see protected area status over the entire study area. Table 10 summarizes the options' ability to meet the PAS criteria. Table 11 summarizes the options socio-economic impacts.

4.1 Option A - No Protected Area Status

PAS Criteria Summary

Option A will make no contribution to the Protected Area Strategy.

The Pinecone Lake - Burke Mountain area would not contribute to current representational gaps in the Southern Pacific Ranges ecosection. Other currently approved study areas and proposed areas of interest would contribute should they become protected, however, fulfilling these gaps will become significantly more difficult without this area.

Protection of archaeological sites is dependant upon further study, particularly in the southern portion, where it is expected that field analysis would enhance knowledge of traditional Katzie use.

The recreation potential for wilderness opportunities particularly in the DeBeck, Boise, and Meslilloet drainages would be lost as timber harvesting and potential mineral extraction could take place. Opportunities for other forms of recreation would occur within the context of multiple resource management.

Socio-Economic Impacts Summary

Under Option A, direct employment relating to the forestry industry is expected to generate 86 jobs that would continue for twenty years. This rate would increase to 134 jobs as new areas become ready for harvesting and would last approximately twenty

Table 10. Summary of PAS Criteria and Options

	Option A No Protection	Option B Partial Protection	Option C Full Protection
Conservation Values	<ul style="list-style-type: none"> - no contribution to current gaps in representation - loss of opportunity to contribute to large gap in CWHdm subzone 	<ul style="list-style-type: none"> - protects 4000 ha. of CWHdm (gap is 16512 ha.) - protects 1835 ha. of CWHvm1 (gap is 3316 ha.) - protects 3750 ha. of CWHvm2 (gap is 11280 ha.) - natural and mature areas occur on Burke plateau and higher elevations around Widgeon Valley - some potential for educational and research programs in mature areas 	<ul style="list-style-type: none"> - protects 5394 ha. of CWHdm (gap is 16512 ha.) - protects 2038 ha. of CWHvm1 (gap is 3316 ha.) - protects 7531 ha. of CWHvm2 (gap is 11280 ha.) - natural and mature areas also include DeBeck, Boise and almost all areas in northern portion - significant educational and research potential in old growth and wilderness of Boise, Homer etc.
Cultural Heritage Values	<ul style="list-style-type: none"> - protection of archaeological sites dependant on further study 	<ul style="list-style-type: none"> - protects potentially high archaeological areas in Widgeon Valley, Burke Mountain, and the west side of Pit Lake 	<ul style="list-style-type: none"> - protects Burke, Widgeon areas as well as medium potential areas in DeBeck Valley
Recreation Values	<ul style="list-style-type: none"> - continued use of established hiking trails 	<ul style="list-style-type: none"> - opportunity for four season activities on Burke Mountain and in Widgeon Valley - development of traditional backcountry features such as standard trails, warming huts, wilderness camp sites 	<ul style="list-style-type: none"> - expands options and values - opportunity for long distance trail from Coquitlam to Mamquam Valley - preserves closest old growth wilderness to the Lower Mainland outside current parks

Table 11. Summary of Socio-Economic Impacts

Socio-Economic Impacts	Option A No Preservation	Option B Partial Preservation	Option C Full Preservation
Direct Jobs (Year 1)	86	77	8.6
Direct Jobs (Year 51)	89	32	292
Direct Income (Year 1)	\$2 690 000	\$2 420 000	\$210 000
Direct Income (Year 51)	\$2 780 000	\$995 000	\$5 750 000
Mineral Exploration	- retains extraction options	- loss of opportunity in protected area	- loss of opportunity - loss of Boise Cu-Md deposit
Job loss / relocation	- status quo for forestry/mining jobs - loss of potential tourism/recreation jobs	- loss of land in Fraser TSA - loss of potential forestry jobs in Widgeon - loss of potential tourism / recreation jobs in northern portion	- loss and relocation of some forestry positions at Pitt Lake camp - loss of small business harvesting in DeBeck
Housing	- status quo	- loss of opportunity in Burke area	- loss of opportunity in Burke area
Hydro	- possible future diversion of Widgeon	- loss of opportunity for Widgeon diversion	- loss of opportunity for Widgeon diversion

Note: Job and income figures from Pinecone Lake - Burke Mountain PAS Study Area Draft Socio-Economic Assessment, 1993

years. The job rate would then fall to 89 direct jobs under a sustained scenario. This corresponds to a direct annual income of \$2.69 million, rising to \$4.21 million during the twenty year span, and settling to a \$2.78 million level. Government revenue under Option A would be greater than the other options for the first seven years. Indirect or spin-off employment related to forestry activities are expected to be 128 jobs for the first twenty years, 201 jobs as second growth areas become available, and settle to 132 jobs on a sustained basis.

Mining and housing opportunities would remain as potential development projects should economic conditions allow. Hydro development such as proposed water diversion from Widgeon Lake could be a possibility if warranted.

Environment impacts on the area would result as logging and possible mining activities take place over the long term. The most notable impacts would occur to the old growth related species and the area's natural diversity.

Social impacts under the options would primarily be felt by two groups; forestry and related workers and recreationalists. Option A would see the continuation of harvesting jobs at the Pitt Lake operation, as well as small business jobs in DeBeck Valley. Fewer backcountry recreational opportunities would be available under Option A.

4.2 Option B - Partial Protected Area Status

Option B would protect the Burke Mountain area as well as the Widgeon Valley, and part of the West Pitt area. This is shown in Map 6.

PAS Criteria Summary

The ability of the entire study area to meet PAS criteria has previously been discussed in Section 3. Option B would protect the Burke Mountain area, Widgeon Valley watershed and some of the West Pitt Lake areas. Therefore, not protecting the other portions of the study area results in a loss towards meeting the criteria.

Option B would preserve approximately 75% of the CWHdm subzone available in the study area. This subzone is greatly under-represented within existing protected areas as only 2% is currently preserved. The current overall CWHdm gap of 16 512 ha. in the Southern Pacific Ranges would be reduced to a gap of 12 467 ha. The option would also preserve about 90% of the CWHvm1 variant and 50% of the CWHvm2 variant available in the entire study area. However, no large areas would be protected that could be defined as natural with old growth valley bottom forests. The area protected under Option B would not be considered wilderness.

The recreation opportunities of Burke Mountain and Widgeon Valley contribute greatly to the recreation criteria of the PAS. There is a long history of the Burke - Widgeon areas proposed as park because of the outstanding recreational and special features associated with the area.

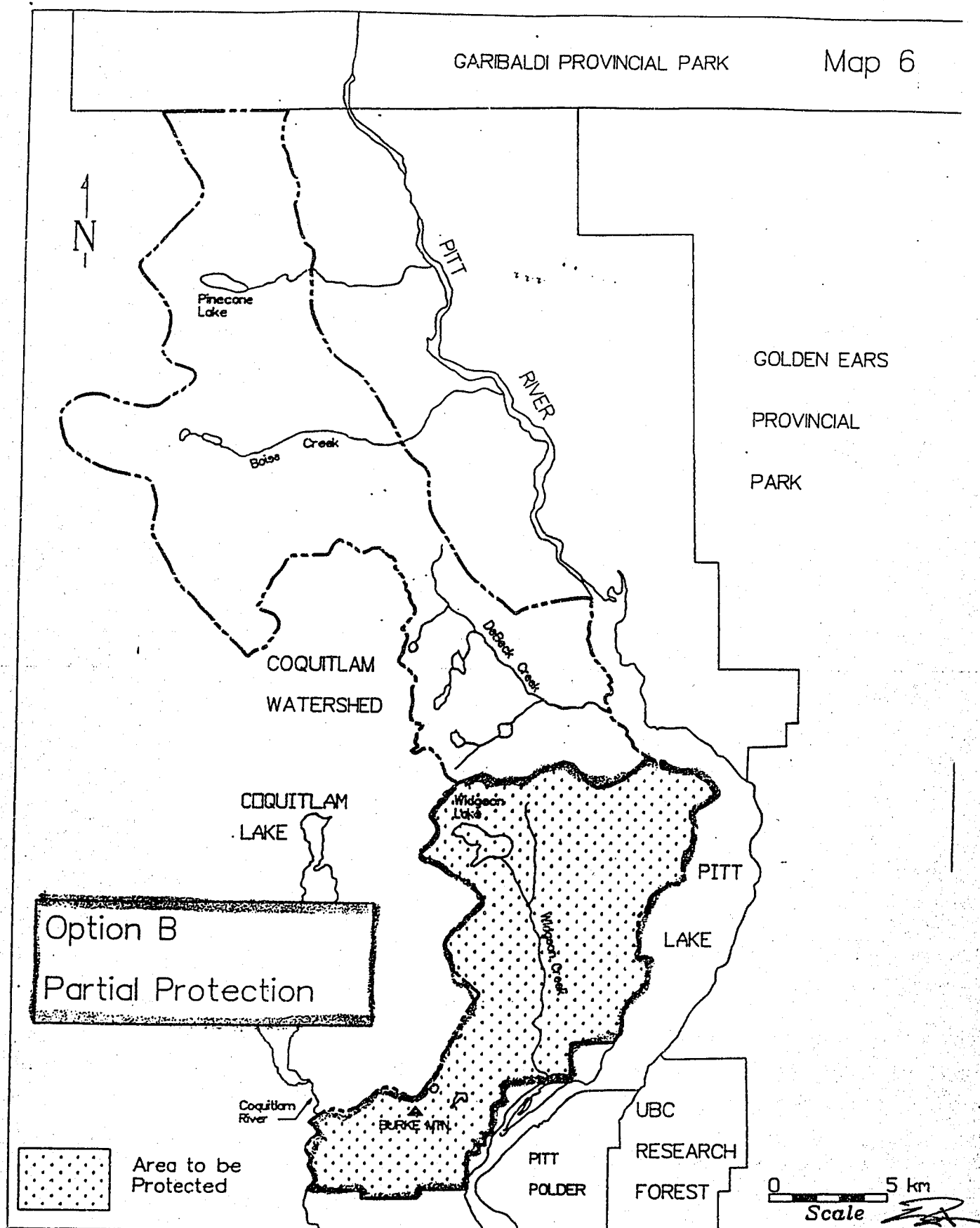

Option B would preserve the special features of Widgeon Valley, Widgeon Falls, Widgeon Lake, Burke Mountain, and the west shore of Pitt Lake. These areas also allow for extensive recreation in all four seasons. Possible development of the area may include an expanded trail network suitable for nordic skiing, warming huts, and backcountry camping sites.

There would also be an association to adjacent established protected areas such as the National Wildlife Reserve and the Widgeon Marsh Regional Park Reserve.

Cultural heritage values under Option B would largely be preserved for known areas. Field analysis may reveal significant areas both inside and outside the boundary for Option B. At this time, only medium potential sites of DeBeck and Pinecone Valleys would be dependant upon further study.

Socio-Economic Impacts Summary

Forestry jobs, under Option B, would continue for those based at the Pitt Lake operation. The loss of the lower portion of the study area to the Fraser TSA would impact jobs in general to the forest industry, though not as great an impact as under Option C.

Option B would lead to a reduction in land available for metallic, and non-metallic, mineral exploration and development. The known showings indicate that the geological conditions needed to create mineral deposits were met. The showings are poorly delineated and their significance is not fully known. They may not be representative of the full range of opportunity present in the area. The reduction in land base available for exploration and possible future development would result in a possible cost to the Province in foregone exploration and possible development. The area is encumbered by four mineral claims.

Housing potential in the Burke area will be lost under this scenario and potential hydro diversion of Widgeon Lake not be available under this scenario.

The greatest social impact under Option B would occur to recreationalists as the wilderness values offered in the northern portion of the study area would be lost. A long distance trail from Coquitlam to Squamish may still be possible, however, this would not include the experience of hiking through valley bottom old growth wilderness areas.

4.3 Option C - Full Protected Area Status

Option C would preserve the entire Pinecone Lake - Burke Mountain study area. This is shown on Map 7.

PAS Criteria Summary

Option C contributes to the representational gap of the Southern Pacific Ranges by preserving the under represented CWHdm, CWHvm1, and CWHvm2 variants. The gap in the CHWdm

GARIBALDI PROVINCIAL PARK

Map 7

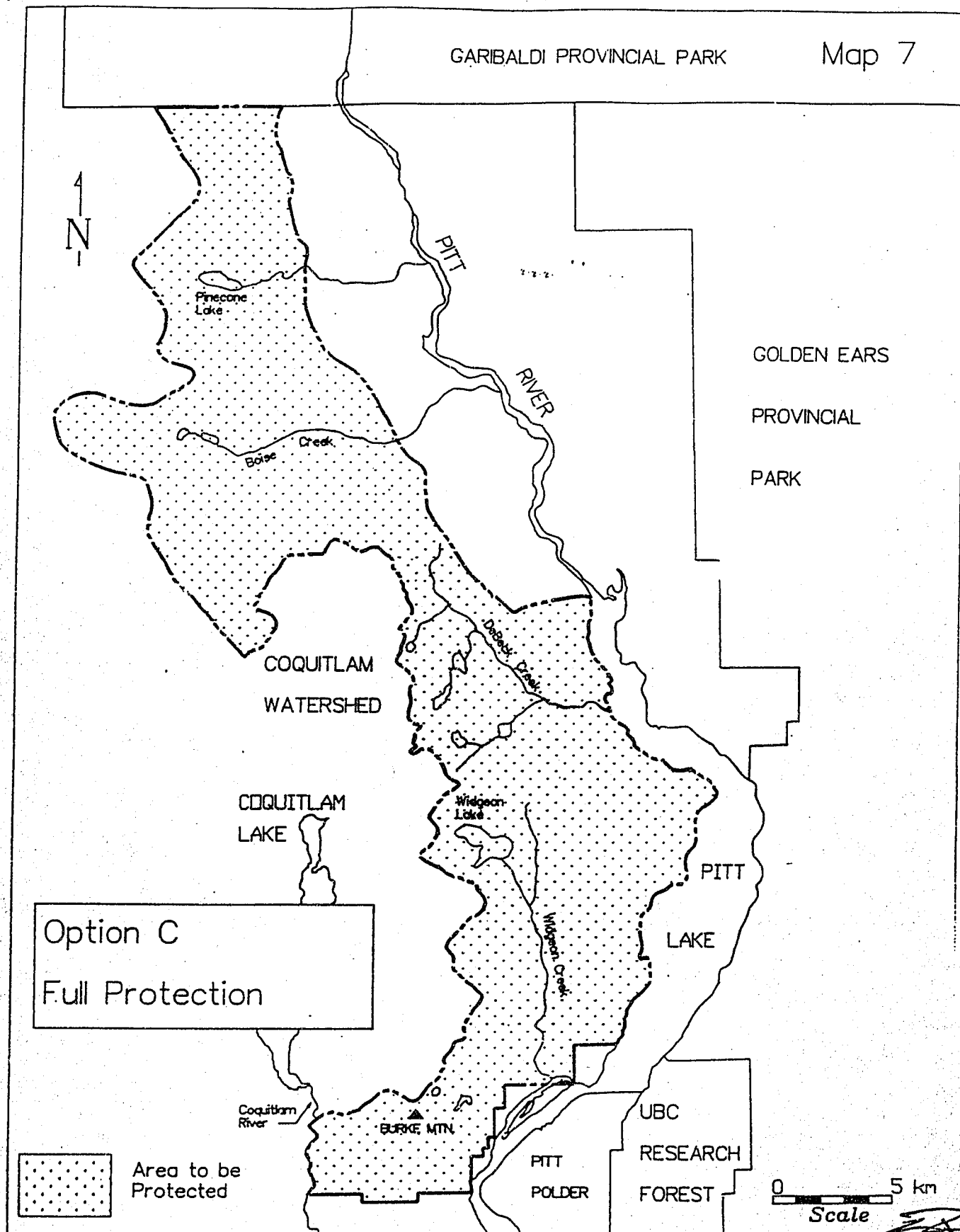

APR 20 1994

subzone would be reduced to 11 118 ha. from 16512 ha. The gaps in the CWHvm1 and CWHvm2 variants would be reduced to 1278 ha. (down from 3316 ha.) and 3749 ha. (down from 11 280 ha.) respectively. The large valleys of Boise and DeBeck would preserve much needed old growth, valley-bottom forests, as well as the closest wilderness to Vancouver outside of current protected areas. Option C also contributes to the PAS criteria by protecting a variety of complete drainages such as the Widgeon, DeBeck and upper Boise and Homer watersheds.

Recreation opportunities for Option C would include the close, easily-accessible features of Burke Mountain and Widgeon Valley, as well as the experiences associated with the remote wilderness of DeBeck and Boise valleys. This option would produce the largest diversity of recreation opportunities.

Option C would ensure the protection of all known and unknown archaeological sites within the study area. Written information states that Katzie use of the northern portion of the study area was probably low, although the Katzie Band feels that there was extensive use of the entire area for hunting and gathering. This option would protect any possible sites that may be discovered north of DeBeck Creek.

Socio-Economic Impacts Summary

Direct employment in Option C from tourism is estimated to begin at a level of 8.6 jobs, growing to 292 jobs after fifty years. There is no levelling off period as the number of people using the area would continuously increase. Direct income under Option C would be significantly lower than under Option A until forty years, when the income level surpasses the levels of Option A. The range extends from \$0.21 million in year 1 to \$5.75 million in year 51. Government revenues for Option C will be higher than under the other options after seven years., growing to an estimated \$11,200,000 after 50 years.

~~There would be job loss and relocation under Option C to both the local timber harvesting companies, and to the forest industry in general through a reduction in the Fraser TSA. While some forestry jobs would be lost at the Pitt Lake operation, some would be relocated to other operating areas, and up to twelve positions lost. This would create significant social concerns to those affected.~~

Option C would lead to a further reduction ~~in land available for exploration and possible future development than Option B.~~ It would incur a possible cost to the Province in terms of opportunity loss and compensation of tenure holders. The Boise Creek copper-molybdenum deposit has not been fully delineated. It is of considerable future exploration significance.

No further hydro or housing implications beyond those discussed under Option B would pertain to Option C since these development scenarios are concerned with Burke Mountain and Widgeon Lake.

Burke-Pinecone proposals ●topic for public Tuesday

PARKLAND: The public gets its say on future of wilderness area

By Sandy Macdougall
Staff Reporter

Decision time is growing short for the Pinecone Lake-Thurice Mountain wilderness area study.

Following months of meetings and discussions, the team appointed by the province to consider the wilderness area proposal has issued a report which the public can review and comment on.

A series of meetings will be held this week in various communities to allow public review and comment on the study team's findings.

Billed by preservationists as a wilderness in Vancouver's backyard, the 38,000-hectare site includes some of the few remaining stands of old-growth timber in the Lower Mainland and within relative easy access by the metropolitan area's 2.6 million people.

team and executive director of the Western Canada Wilderness Committee, said the public meetings represent an opportunity to make history by showing the provincial government that there is widespread support for designation of the wilderness area as a Class A provincial park.

"History is only made by the people who show up," Foy said, urging residents to attend public meetings scheduled for this week.

Holders of timber rights have argued that protection of the entire area will alienate timber supplies and result in job losses.

However, the study team's economic analysis states that the number of direct jobs would eventually be far greater than if the area is logged.

One study team member said the old-growth stands could be saved and more forest industry jobs

would be created if more value added products were manufactured in this country.

The study team's report includes three options ranging from no protection to full protection of the entire 38,000 hectares.

The public is also invited to make recommendations which the study team will consider before preparing its final report for the provincial cabinet.

A decision on the future of the proposal is expected later this year.

One of the public meetings will be held Feb. 15 in the Mike Butler Room of the Dogwood Pavilion, 624 Poirier St., Coquitlam.

An open house will begin at 5 p.m. and will be followed by a meeting scheduled to begin at 7:30 p.m.

Other public meetings will be held in Chilliwack, Vancouver and Squamish.

IN BRIEF

Paid fund- raisers are unwelcome

The Coquitlam School Board supported a new fundraising policy for school at their meeting Tuesday.

But they do not support the idea of hiring paid professionals to raise

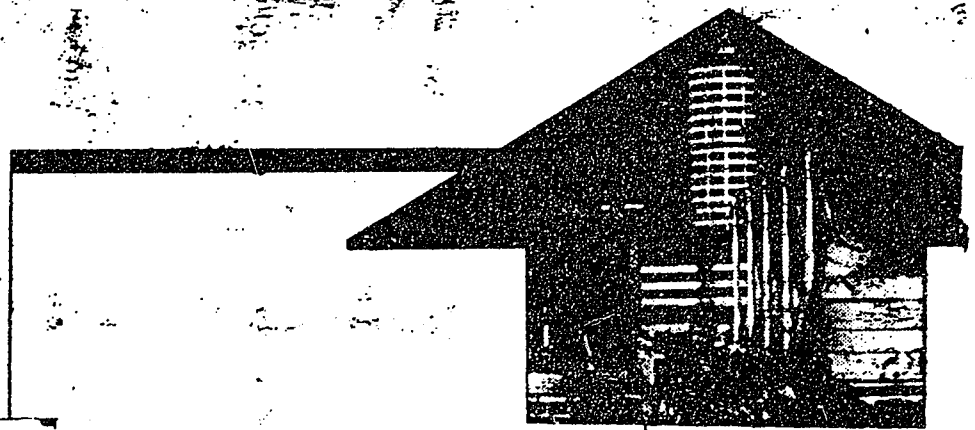

WILSON

FAM

WOL

DR

TO

D

HEALTH

21

F

C

you

APR 2 0 1994

THE CORPORATION OF THE
CITY OF PORT COQUITLAM

Other Business. (1)

MEMORANDUM

TO: Environmental Protection Committee DATE: April 18, 1994

FROM: Anne T. Pynenburg
Project Technician

SUBJECT: UPDATE ON SEABOARD ADVERTISING/G.V.R.D. TRANSIT SHELTER
CAMPAIGN

BACKGROUND & COMMENTS:

Attached is a previous report submitted to the EPC for consideration of the 5 advertising campaigns set out by the G.V.R.D. involving waste reduction and environmental issues.

Two of the campaigns, the Composting slated for fall and the Telephone Book Recycling in June will use the same posters as last year. (See attached) For the other 3 campaigns, Air Quality, Water Conservation and Christmass Wrapping Waste Reduction, the ads have not been written yet and will not be available for our comments.

A copy of the posters used in all the Transit Shelter Ads will be sent to us by the G.V.R.D. a week or so before the campaign begins.

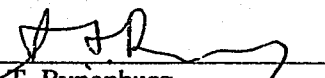
Anne T. Pynenburg
Project Technician

attach

*Approved. Go to CC. for
authorization*

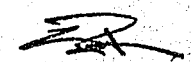
APR 20 1994

THE CORPORATION OF THE
CITY OF PORT COQUITLAM

MEMORANDUM

TO: Environmental Protection Committee

DATE: April 06, 1994

FROM: Anne T. Pynenburg
Project Technician

SUBJECT: SEABOARD ADVERTISING/G.V.R.D. TRANSIT SHELTER CAMPAIGN

RECOMMENDATION:

That the Environmental Protection Committee support, through donation of municipal advertising space, all Transit Shelter Campaigns EXCEPT Phone Book recycling campaign.

BACKGROUND & COMMENTS:

Attached is a letter from the G.V.R.D. Communications and Education Dept. requesting that the City send a letter to Seaboard Advertising giving permission to use our municipal ad space on bus shelters.

All municipalities are given 10% free advertising space from Seaboard Advertising to be used by the municipality for their own purposes. In the past, most municipalities have not taken advantage of this space.

The G.V.R.D. would like to use this space in 1994 for several advertising campaigns aimed at environmental issues and waste reduction. The five campaigns are:

Air Quality
Phone Books
Water Conservation
Composting
Christmas Wrapping

I support four of the campaigns with the exception of the Phone Book Recycling Campaign. My reasons for taking a second look at this are:

BC Tel is a private company with their own resources to fund their own advertising, phone books only make up from 0.6 to 1.2% of Port Coquitlam's solid waste stream, a better campaign would be to target newspapers which make up approx. 60% of our waste stream, and the question is not necessarily one of monetary value but of political value; ie. Port Coquitlam singling out one producer of waste and offering them our advertising space albeit free space.

Anne T. Pynenburg
Project Technician

attach



73 TEAMITE OVERHEAD

APR 20 1994

treadful sound-
ing.
is not the worst
irritating
this man is los-
ing hearing, coun-
ty? How will he
he strides
mortal Vien-
wa, muttering
he walked the

t, my dear. We
s amiss when
his name.
gal title of
am proud to
ame. But this
g insists on
ommon
lover from
wooden

linna darling.
ous talent,
has too
ainst him to
the compet-
Vienna. So
he will be
and never
ing
alls the ter-
n!

ts

week and a
is the only

in these or
nities, the
steer Cen-
rview.
e 10 a.m.
gh Thurs-
Wednes-

RT

TH
r Van-
is fast-
ideal-
such as
117s
om-
range

CRD's
serv-
Port
relat
of

They just get recycled.

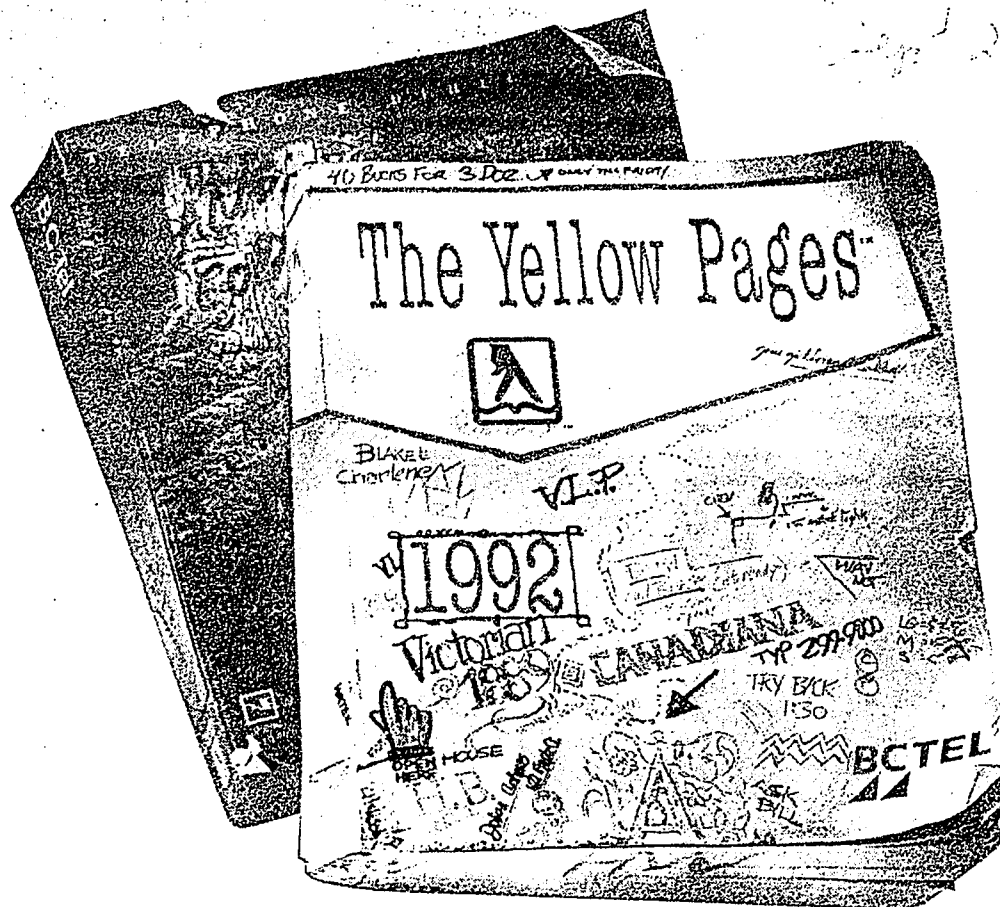

We make it clean and simple for you to recycle your phone books.

In Coquitlam, take it to:
Newstech Recycling, 1050 United Blvd., Coquitlam

Port Moody residents use the sea through bag with your curbside program.

~~Burnaby~~ Port Coquitlam residents use the yellow bag with your blue box.



SPONSORED BY:

City of Port Coquitlam, City of Port Moody,
City of Coquitlam and BC TEL



The News Classified

THE CORPORATION OF THE
CITY OF PORT COQUITLAM

O.P. (2)

MEMORANDUM

TO: Environmental Protection Committee DATE: April 19, 1994

FROM: Anne T. Pynenburg
Project Technician

SUBJECT: EARTH DAY DONATIONS - EARTHWISE MAGAZINE

BACKGROUND & COMMENTS:

Earthwise magazine is setting up a display at Granville Island for Earth Day celebrations on April 22, 1994. Earthwise will be holding a prize draw for various green products. They are asking the City of Port Coquitlam to donate a worm composter to this event.

The benefit to the City is that we will get recognition for donating the composter. The cost to enter the prize draw is by donation and the proceeds will go to Earthwise Magazine Ltd.

While I think it is a good idea to participate in some form in Earth Day celebrations, I think that the money spent on donating a worm composter would be better kept to our municipality; possibly by purchasing another worm composter for the Wilson Centre or one of the local schools.

Anne T. Pynenburg
Project Technician

Approved.
Engineer of Wilson Centre
would like a worm
composter. Pay.

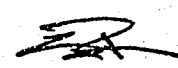
APR 20 1994

MEMORANDUM

TO: Environmental Protection Committee

DATE: April 19, 1994

FROM: Francis K.K. Cheung, P. Eng.
Project Engineer

FILE No: EPC

SUBJECT: PROPOSED TREE PLANTING LOCATIONS - BFI DONATION

RECOMMENDATION:

- ✓ That Committee review the three proposed locations for tree planting in the City:
- i. South end of Thompson Park (See Figure 1).
 - ii. South side of Kingsway Avenue between Coast Meridian Road and Konings Ltd (See Figure 2).
 - iii. Along the dyke at Kebet Way (See Figure 2).
- ✗ That Committee instruct the Engineering Department which option we should undertake.
- ✓ 3. That Committee participate in a public appreciation ceremony to thank BFI Ltd. for contributing towards environmental enhancement project in the City once the tree planting is completed.

BACKGROUND & COMMENTS:

At the regular EPC meeting on April 13, 1994, the Committee instructed the Engineering Department to review the three proposed locations for tree planting in the City.

Mr. Bill Herbst, City Gardener, and I investigated the three most suitable locations for tree planting in the City:

1. South end of Thompson Park (See Figure 1).
2. South side of Kingsway Avenue between Coast Meridian Road and Konings Ltd. (See Figure 2).
3. Along the dyke at Kebet Way (See Figure 2).

The boulevard at Connaught Drive along Thompson Park already have sufficient trees planted; therefore, Mr. Herbst recommended to plant a buffer of trees at the south end of Thompson Park. The buffer of trees will act as a buffer between the residents on Connaught Drive and the industrial area.

The south side of Kingsway Avenue between Coast Meridian Road and Konnings Ltd. is a suitable location for tree planting. Konnings Ltd. already have planted a strip of trees along the front of their property; therefore, tree planting along the remaining section will complete the entire block. Mr. Herbst recommended that 15 to 20 Silver Maple trees, at 30 feet spacing, will complete this section of boulevard. Mr. Herbst estimated that the cost for the trees will be approximately \$2,000 and cost for labour and preparation work will be approximately \$3,000.

Along the dyke at Kebet Way is the most suitable location for tree planting since the trees will provide an aesthetically pleasing environment for people walking along the dyke. The entire section of dyke from Kingsway Avenue to Peace Park will then have a strip of tree buffer once this section of dyke is planted with trees. However, Mr. Herbst estimated that approximately 50 trees, at an estimated cost of \$12,500, will be

Cont.'d .../2

APR 20 1994

required to complete this section of dyke.

It is recommended that Committee review the three proposed tree planting locations and instruct the Engineering Department which options we should undertake.

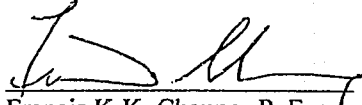

Francis K.K. Cheung, P. Eng.
Project Engineer

FKKC/
attachment

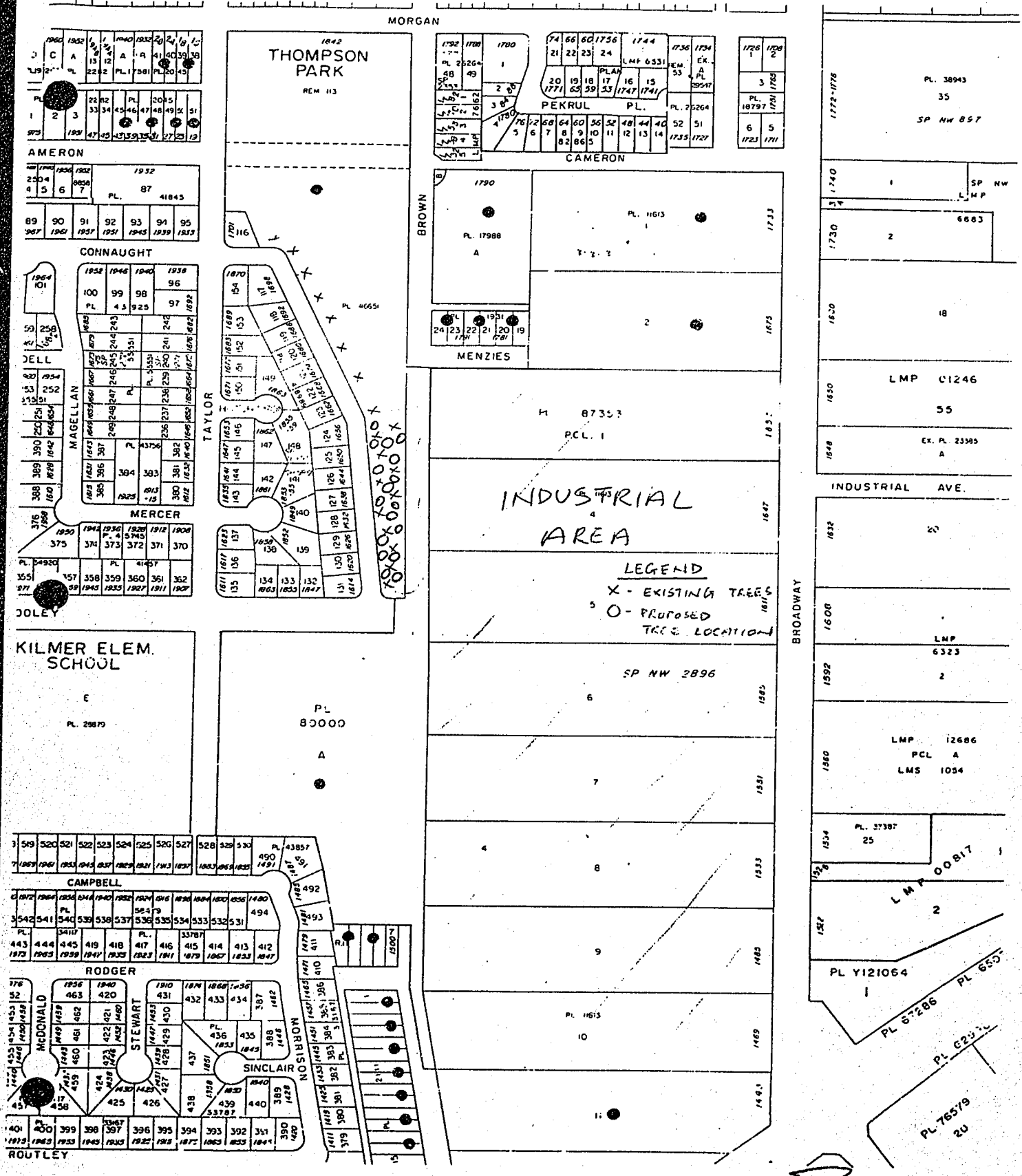

FIGURE 1

APR 2, 1994

↑

43

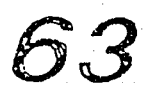

FIGURE 2.